

GB72U-154T5HO

Suspended Indirect Illumination

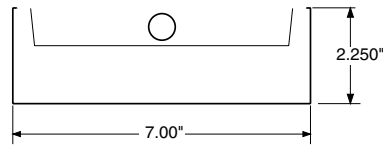

1 x T5HO



GB72U

7.00" wide indirect luminaire

Construction

Housing: Extruded aluminum body 7.00" wide x 2.25" high, 6063T5, 0.065" minimum thickness. Available in one piece, unbroken lengths up to 20' with just two points of suspension.

Joiner System: Automatic alignment, no loose parts, one tool to tighten two factory installed bolts for a hairline seam. No light leaks.

Ballast: Osram - Sylvania or equal electronic **RS** ballast with less than 10% THD is standard: **ERS**.

Mounting and Feed: Aircraft cable is 7x7 stranded stainless steel with machined stainless steel stopper fitting at the top end. Lower end strands are welded and ground for easy insertion into continuously adjustable cable gripper. Feed cord is straight, white 3/C SVT or SJT #18 AWG. Coiled cord is available (specify **CC**).

Stems are 3/8" schedule 40 pipe with top swivels. California UBC compliant stems with internal safety cables available (specify **SEQ**).

Electrical

UL listed wiring and components throughout. Housing is completely wired with quick-connect plugs at all mating joints and individually tested. No fixture disassembly and no field wiring is required to install rows.

All fixtures bear UL & CUL Dry Location labels. Damp Location labels are available. Specify **DL** in the Options field.

Optical Performance

Reflectors: Specular peened aluminum, 95% reflectance.

Performance: Independent photometric laboratory testing - ITL or equal - is required. Luminaire is 83% efficient.

Finish

Housing assembly is electrostatically sprayed with high solids aliphatic two component polyurethane to an average thickness of 2 mils. over acid etching primer. Specify **H** for high gloss in Paint Finish field. Specify **SG** for semi gloss.

Standard Features

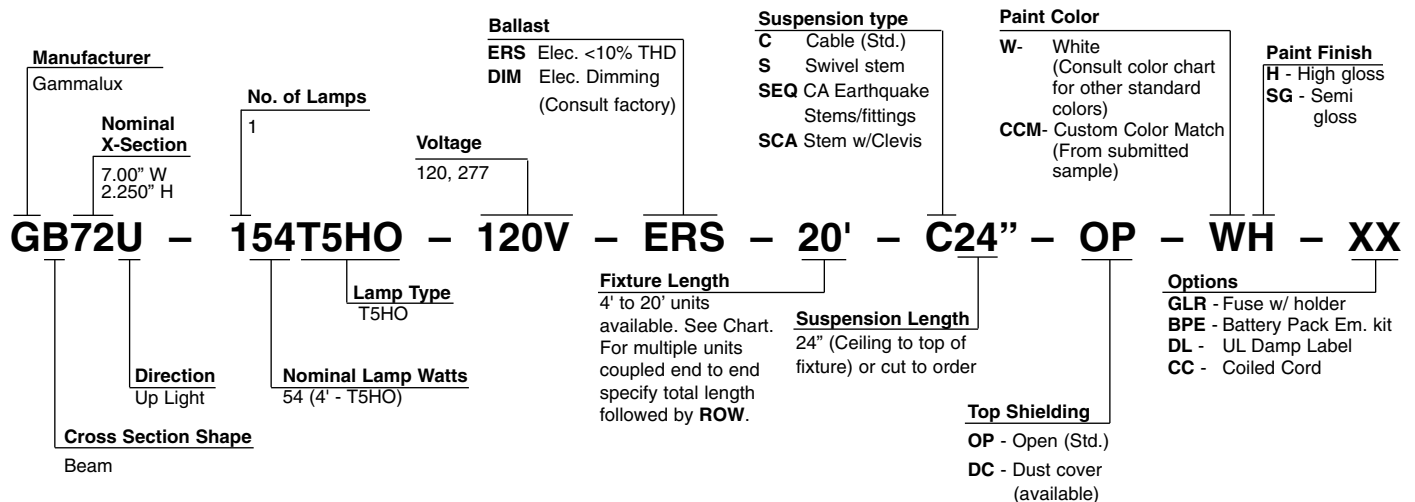

Photometric Report

GB72U-154T5HO-120VERS-4'-C24"-OP-PT

Test: ITL #53523 04/01/03

IES Datafile: ITL53523.IES

Lamp: 1-F54T5HO (5000 lumens)

83.7% Efficiency

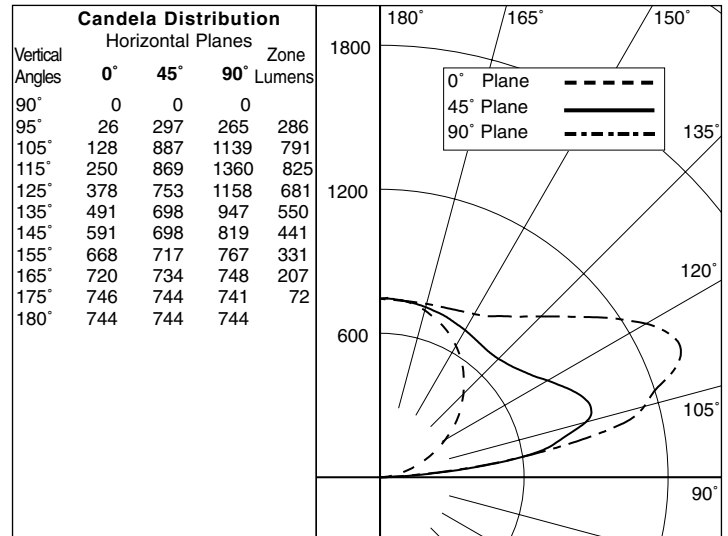
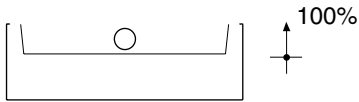

Coefficients of Utilization – Zonal Cavity Method

Effective Floor Cavity Reflectance (rfc) = 0.20

RCC	80%				70%				50%			30%		
	70%	50%	30%	10%	70%	50%	30%	10%	50%	30%	10%	50%	30%	10%
RCR														
0	.80	.80	.80	.80	.68	.68	.68	.68	.46	.46	.46	.27	.27	.27
1	.72	.69	.66	.63	.62	.59	.57	.55	.40	.39	.38	.23	.23	.22
2	.66	.60	.56	.52	.56	.52	.48	.45	.35	.33	.31	.20	.19	.18
3	.60	.53	.47	.43	.51	.45	.41	.37	.31	.28	.26	.18	.17	.15
4	.55	.47	.41	.36	.47	.40	.35	.31	.27	.24	.22	.16	.14	.13
5	.50	.41	.35	.30	.43	.35	.30	.26	.24	.21	.19	.14	.12	.11
6	.46	.37	.30	.26	.39	.31	.26	.23	.22	.18	.16	.12	.11	.10
7	.42	.33	.27	.22	.36	.28	.23	.20	.20	.16	.14	.11	.10	.08
8	.39	.30	.24	.20	.33	.25	.20	.17	.18	.14	.12	.10	.08	.07
9	.36	.27	.21	.17	.31	.23	.18	.15	.16	.13	.11	.09	.08	.06
10	.33	.24	.19	.15	.29	.21	.16	.13	.14	.11	.09	.08	.07	.06

Mtg. Dimensions

For individual rows of luminaires with cable or stem suspended mtg.

